

8" Side Port Pressure Vessel 600 psi (41.4 bar)

ORDER REFERENCE
See Box Below

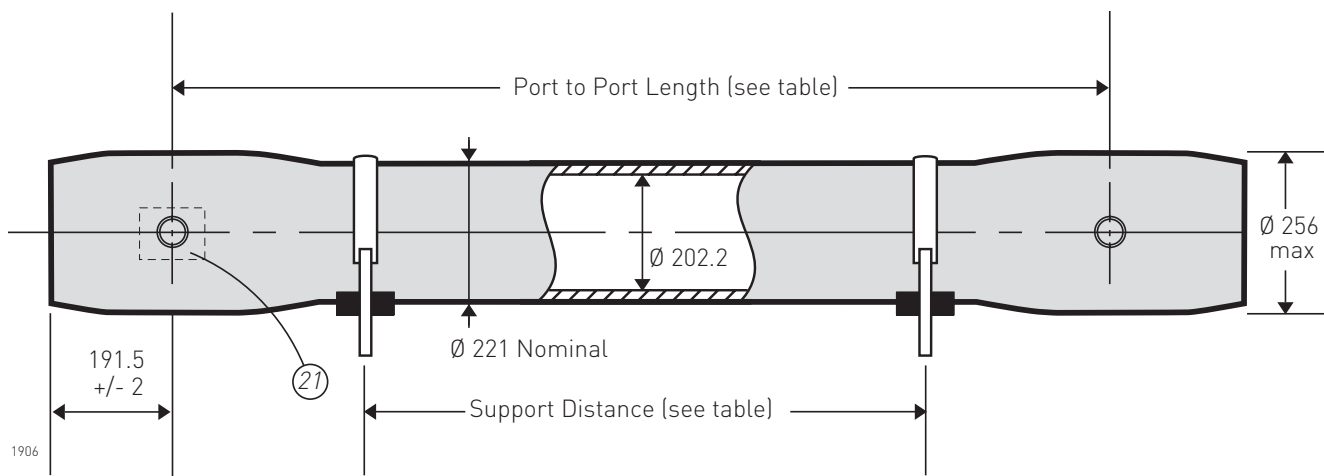

Working Pressure: 600 psi
Assembly Drawing: 1MNC 1906

Working Temperature: -7° to 45°C
Design Code: ASME X

Body of vessel is manufactured completely from glass reinforced epoxy resins. Pressure vessels can be produced to cover all leading manufacturers membranes regardless of length. Please advise membrane type and length when requesting further details. Please adhere to recommended support positions, if in doubt contact Phoenix Vessel Technology.

Feed and concentrate connections: 1.5" or 2.0" Victualic (For options see reverse).

Product connections: 1.0" BSP Parallel (Male) or 1.0" NPT (Female).

Order Reference	No of 40" Elements	Port to Port Length +/-1mm	Max Support Position	Min Support Position	Max Dry Weight
8S600X.1	1	1143	800	500	52 kg
8S600X.1.5	1.5	1651	1310	500	59 kg
8S600X.2	2	2159	1810	500	66 kg
8S600X.3	3	3175	2830	960	81 kg
8S600X.4	4	4191	3190	1970	96 kg
8S600X.4.5	4.5	4699	3375	2480	103 kg
8S600X.5	5	5207	3560	2990	110 kg
8S600X.6	6	6223	4020	4020	125 kg
8S600X.7	7	7239	6170 c	5090 c	140 kg
8S600X.7.5	7.5	7747	6220 c	5330 c	147 kg

All dimensions in mm. c = Central support required.
All dimensions and weights are nominal unless stated otherwise.

This data sheet supersedes all previous issues.
Product Code: 8S600X 09/06

8" Side Port Pressure Vessel 600 psi (41.4 bar)

ORDER REFERENCE

See Overleaf

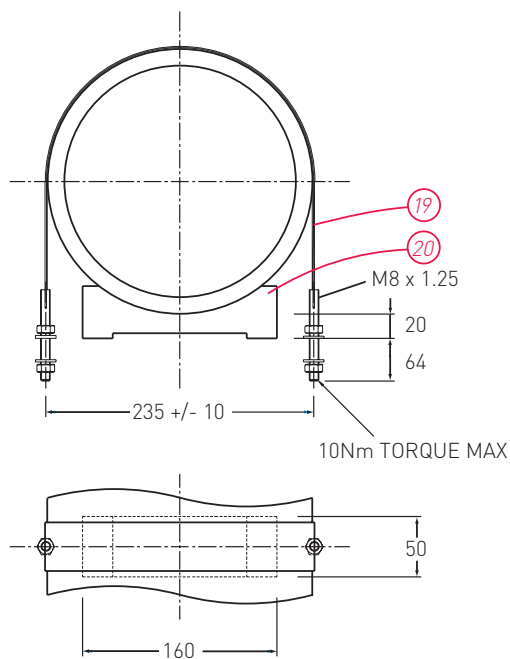
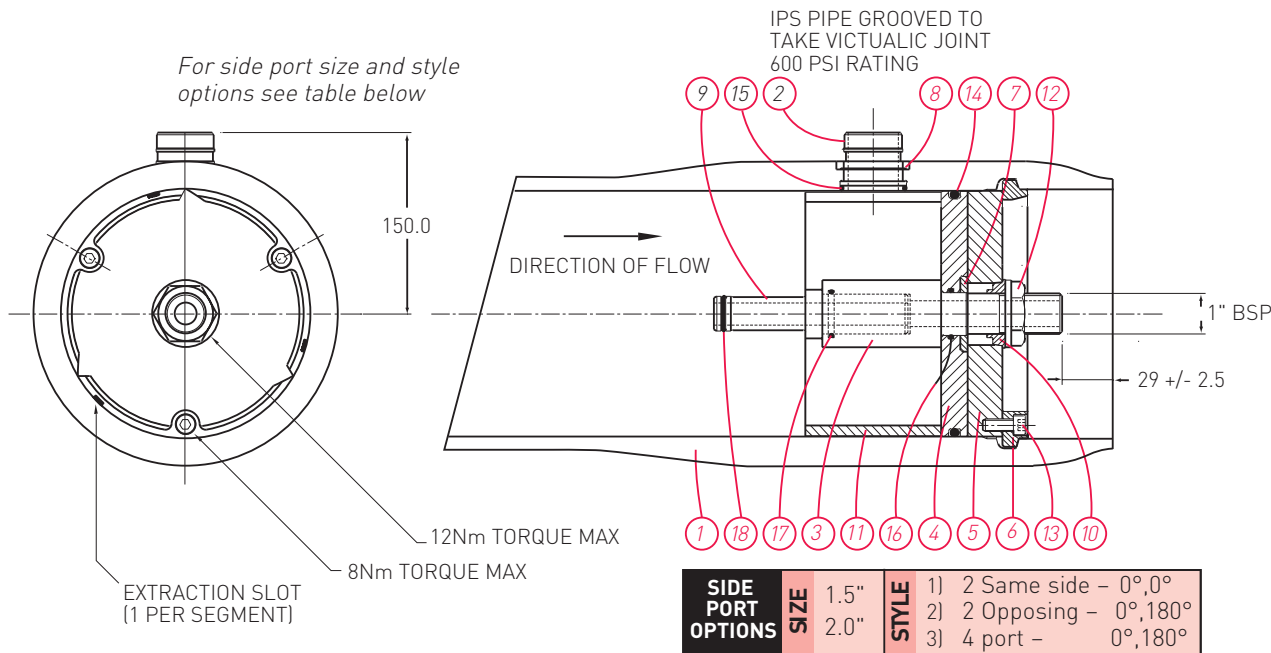

Tighten all bolts/nuts to 50% of the maximum torque figure.

DO NOT EXCEED THE MAXIMUM TORQUE.

For lubricants and general assembly refer to the [User Guide on our website](#).

Item	Description	Material	Part No.	No. off
1	Vessel Body	Glass Fibre Epoxy Resin	BDY 2139	1
2	Feed/Concentrate Port	St. Steel 316L 1.5" Port St. Steel 316L 2.0" Port	CMP 1863 CMP 1990	2/3/4 2/3/4
3	Product Port	Thermoplastic	CMP 1945	2
4	End Plate	Thermoplastic	CMP 1947	2
5	Backing Plate	Anodised Aluminium	CMP1948	2
6	Retaining Ring Segment	St. Steel 316	CMP 1469	6
7	Support Washer	St. Steel 316	CMP 1888	2
8	Spiroloc Circlip	St. Steel 302 1.5" Port St. Steel 302 2.0" Port	CMP 1950 CMP 2029	2/3/4 2/3/4
9	Adaptor	Thermoplastic	To suit membrane	2
10	Anti-rotation Collet	Thermoplastic	CMP 1892	2
11	Thrust Ring	Thermoplastic	CMP 3069 ASSY	1
12	1" BSP Backnut	Thermoplastic	CMP 1179	2
13	Cap Head Screw	St. Steel Grade A4	CMP 1520	6
14	'O' Seal Endplate	EPDM	BS882	2
15	'O' Seal Feed Port	EPDM 1.5" Port EPDM 2.0" Port	BS225 BS229	2/3/4 2/3/4
16	'O' Seal Hub/Endplate	EPDM	BS220	2
17	'O' Seal Prod/Adaptor	EPDM	BS219	2
18	'O' Seal Adaptor	EPDM	To suit membrane	2/4
19	Strap	St. Steel/Neoprene	CMP 1211	2/3
20	Saddle	Urethane	CMP 1075	2/3
21	Nameplate	Aluminium or Vinyl	Not Available	1

The company reserves the right to alter specifications without prior notice.
This data sheet supersedes all previous issues. Product Code: 8S600X 09/06