

PRESSURE VESSEL / Stainless Steel

PVS- 4040 - x - 600 - SP - TC

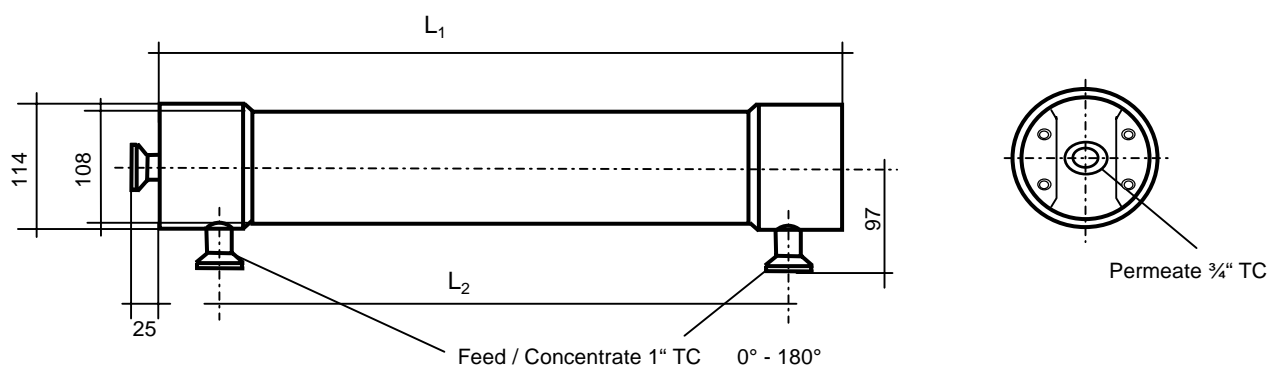

- Pressure range: up to 41 bar / 600 psi
- Temperature range: up to 85°C
- for all types of membrane elements
- on request with quality certification
- Material 316L / 1.4571
- including all necessary seals (EPDM) and internal adapters
- on request up to 4 side-port connections possible
- TC-connections in „Zoll“-Standard



D₁ = 108 mm

D₂ = 116 mm

Art. No.	Type	Elements per PV	Length L1 in mm	Length L2 in mm	Feed connection	Concentrate connection	Permeate connection	Material
433 207	PVS-4040-1-600 - SP- TC	1	1100	995	1"- TC	1"- TC	3/4"- TC	316L
433 217	PVS-4040-2-600 - SP- TC	2	2115	2010	1"- TC	1"- TC	3/4"- TC	316L
433 227	PVS-4040-3-600 - SP-TC	3	3130	3025	1"- TC	1"- TC	3/4"- TC	316L
433 237	PVS-4040-4-600 - SP- TC	4	4150	4045	1"- TC	1"- TC	3/4"- TC	316L
433 247	PVS-4040-5-600 - SP- TC	5	5165	5060	1"- TC	1"- TC	3/4"- TC	316L
433 257	PVS-4040-6-600 - SP- TC	6	6180	6075	1"- TC	1"- TC	3/4"- TC	316L

Pressure Vessel: polished inside, on the outside fine sharpened.

Material: Stainless Steel 316L (1.4571)

Head-Material: 316L (1.4571)

Headfixing: spring washers, stainless steel

PVS-4040-600 SP TC 09/05