

**PRESSURE VESSEL / Stainless Steel**

**PVS- 8040 - x - 400 - EP - VC**

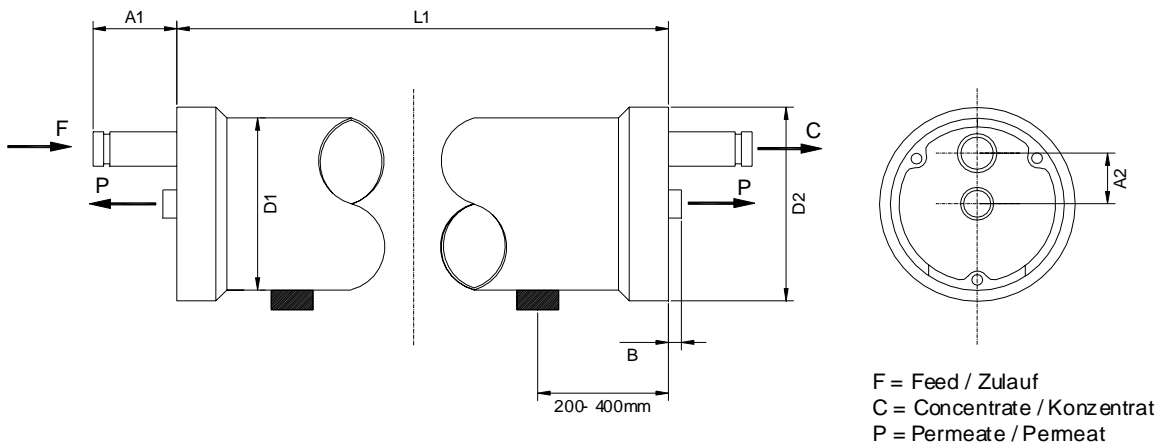

- Pressure range: up to 27.6 bar / 400 psi
- Temperature range: up to 85°C
- for all types of membrane elements
- on request with quality certification
- Material 316L / 1.4404
- including all necessary seals ( EPDM ) and internal adapters



Scope of supply:

for Pressure Vessels: <= 4 Elements incl. 2 Saddles and 2 Straps  
 for Pressure Vessels: >= 5 Elements incl. 3 Saddles and 3 Straps

including plug 1" for permeate outlet

A<sub>1</sub> = 95 mm  
 A<sub>2</sub> = 65 mm  
 B = 15 mm  
 D<sub>1</sub> = 209 mm  
 D<sub>2</sub> = 247 mm

Art. No.	Type	Elements per PV	Length L1 in mm	Feed connection	Concentrate connection	Permeate connection	Material
434 201	PVS-8040-1- 400 - EP- VC	1	1190	1 1/2"-Vict.	1 1/2"-Vict.	1"-BSP F	316L
434 211	PVS-8040-2- 400 - EP- VC	2	2210	1 1/2"-Vict.	1 1/2"-Vict.	1"-BSP F	316L
434 221	PVS-8040-3- 400 - EP- VC	3	3230	1 1/2"-Vict.	1 1/2"-Vict.	1"-BSP F	316L
434 231	PVS-8040-4- 400 - EP- VC	4	4240	1 1/2"-Vict.	1 1/2"-Vict.	1"-BSP F	316L
434 241	PVS-8040-5- 400 - EP- VC	5	5260	1 1/2"-Vict.	1 1/2"-Vict.	1"-BSP F	316L
434 251	PVS-8040-6- 400 - EP- VC	6	6275	1 1/2"-Vict.	1 1/2"-Vict.	1"-BSP F	316L

Pressure Vessel: polished inside, on the outside fine sharpened.  
 Material: Stainless Steel 316L (1.4571)  
 Head-Material: 316L (1.4571)  
 Headfixing: spring washers, stainless steel

